

## Before Using the Product

Before using the product, please read this manual. Make sure that the end users read this manual and then keep the manual in a safe place for future reference.

### ■ Relevant manuals

Before using the product, please read the Safety Guidelines included with the base unit used, especially the following sections.

- SAFETY PRECAUTIONS
- CONDITIONS OF USE FOR THE PRODUCT
- EMC AND LOW VOLTAGE DIRECTIVES
- WARRANTY

The product details are described in the following manual.

Please develop familiarity with the functions and performance of the product to handle the product correctly.

- MELSEC iQ-R CPU Module User's Manual (Startup)  
SH-081263ENG

### ■ *Manuels correspondants*

*Avant d'utiliser ce produit, prière de lire les "Safety Guidelines" (directive de sécurité) fournies avec l'unité de base, en particulier dans les sections suivantes.*

- PRÉCAUTIONS DE SÉCURITÉ
- CONDITIONS D'UTILISATION DE PRODUIT
- DIRECTIVES CEM ET BASSE TENSION
- GARANTIE

### ■ Packing list

Check that the following items are included in the package of the product.

Item	Quantity
Extended SRAM cassette	1
Before Using the Product (this manual)	1

### ■ Insertion procedure

- Turn off the programmable controller.
- Open the cassette cover on the side of the CPU module.
- Hold the top and bottom of the tab of the extended SRAM cassette. Keep the cassette straight, then carefully insert it into the cassette connector.

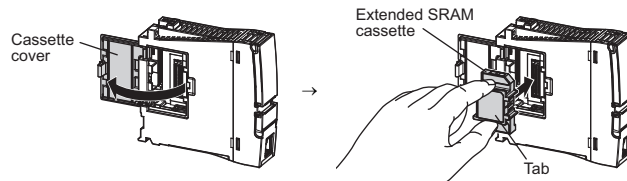

Insert the cassette with the cutoff corner of the cassette in the upper-right side of the CPU module.

### ■ Handling precautions

- Do not directly touch any conductive parts and electronic components of the extended SRAM cassette. Doing so can cause malfunction or failure of the module.
- Securely insert an extended SRAM cassette into the cassette connector of a CPU module. After insertion, close the cassette cover to prevent the cassette from coming off. Poor contact may cause malfunction.

### ■ Operating ambient temperature

Use the product within the range of 0 to 55°C.

### ■ *Température ambiante de fonctionnement*

*Ce produit doit être utilisé entre 0 et 55°C.*

### ■ Information and services

For further information and services, please consult your local Mitsubishi representative.